

For suitable locks and latches please see pages **41-44**

For information on glass preparation, please contact the Architectural Ironmongery department

A 'Fernando' automatic glass door hinge

- For **8-12 mm** toughened glass
- Self closing from any position
- For double action doors **only**
- Max. door weight **60 kg** (per pair)
- Fixings included
- Brass

Finish	Cat. No.
Satin chrome plated	981.14.304
Satin nickel plated	981.14.306

Order qty: 1 pc (2 pcs required per door)

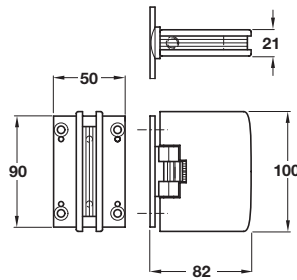

Item B.

*Text removed 'Fixings included'
Please note fixings are NOT included*

B 'Fernando' automatic glass/glass door hinge

- For left or right hand use
- For **8-12 mm** glass thickness
- Max. door weight **50 kg** (per pair)
- Steel

Finish	Cat. No.
Satin chrome plated	981.14.144
Satin nickel plated	981.14.146

Order qty: 1 pc (2 pcs required per door)

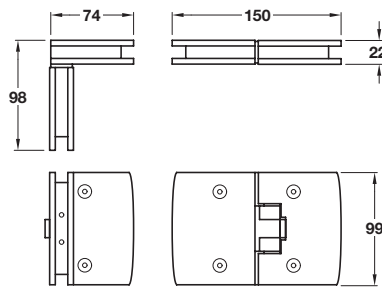

Item C.

*Catalogue shows 97 mm
Correct dimension is
110 mm*

C 'Fernando' automatic glass door hinge

- Heavy duty automatic glass door hinge
- For **8-12 mm** glass thickness
- Max. door weight **75 kg** (per pair)
- Zero position can be set
- Fixings included
- Brass

Finish	Cat. No.
Satin chrome plated	981.14.344
Satin nickel plated	981.14.346

Order qty: 1 pc (2pcs required per door)

