

BS EN 1155

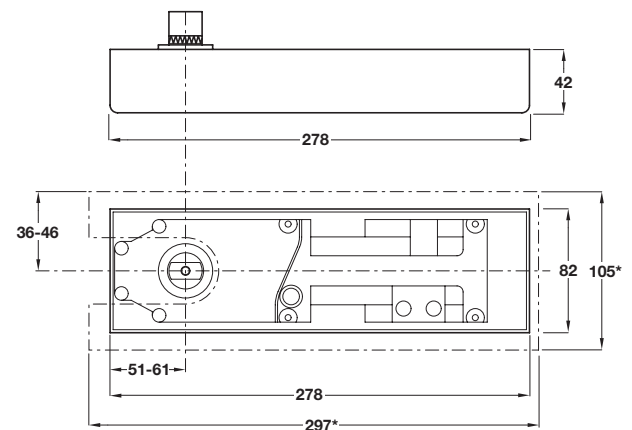

* Dimensions for cover plate (not included - must be ordered separately)

A Floor spring mechanism and box

• Specification

Floor spring mechanism to suit single and double action doors up to 1100 mm wide with flat-tapered, removable interlocked spindle

Adjustable closing force, adjustable closing speed, check back and latch action and hold open version

Spring opening and operational from 170°

Supplied with cement box

• Features

Closing force adjustable (size range EN 1-4)

Adjustable closing speed

Adjustable position with box. (6 mm vertical, 10 mm lateral and 10 mm length)

Backcheck

Safety valve prevents overloading

Closing range from 170°

Suitable for single and double action doors

Maximum door weight 150 kg

Hold open @ 90° (single action only)*, not fire doors

Cover plate not included (see page 62)

Fittings not included (see page 63-65)

• Certification

Tested and approved to BS EN 1154: 19997

Tested to conform to CE requirements

Certifire approved; certificate no. CF259 -

Single 30 mins, double 60 mins

- * For double action doors each hold-open angle is 5° greater. For example, an 85° hold-open version will be 90° in double action mode

- Available to order:

With hold open at 85°, 105° and 120° (single action), all subject to quantity.

Standard (EN size 1-4)

Cat. No.	932.10.050
----------	------------

Order qty: 1 pc

Hold-open version 90° (not suitable for fire door)

Cat. No.	932.10.052
----------	------------

Order qty: 1 pc

Fixed power (Size EN 3)

Cat. No.	932.10.040
----------	------------

Order qty: 1 pc

Closing force

Size	Max. door width	Min. closing moments
1	750	9 Nm
2	850	13 Nm
3	900	18 Nm
4	1100	28 Nm