

Surface Indicator Bolts Aluminium, Zinc Alloy and Stainless Steel

For mortice indicator bolts, refer to Section 2 for lock and Section 1 for emergency indicator and release

Silver anodised finish

A Indicator bolt

- Surface mounted
- To suit doors up to **44 mm** thick
- Emergency release to outside
- Knob slide bolt to inside
- Aluminium

| Finish | Cat. No. |
|-----------------|------------|
| Silver anodised | 911.62.263 |

Order qty: 1 pc

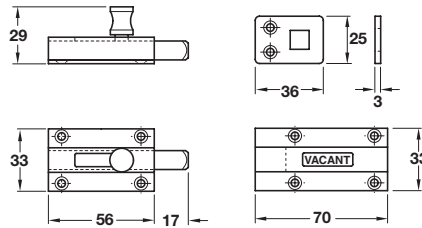

Silver anodised finish

B Indicator bolt

- Surface mounted
- To suit doors **28-48 mm** thick
- Emergency release to outside
- Large slide bolt to inside (suitable for disabled use)
- Aluminium

| Finish | Cat. No. |
|-----------------|------------|
| Silver anodised | 911.62.264 |

Order qty: 1 pc

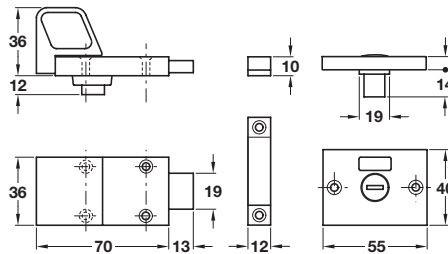

Polished brass finish

C Indicator bolt

- Surface mounted
- To suit doors **28-48 mm** thick
- Emergency release to outside
- Throw over turn knob to inside
- Zinc alloy

| Finish | Cat. No. |
|-----------------|------------|
| Polished brass | 911.62.265 |
| Polished chrome | 911.62.266 |

Order qty: 1 pc

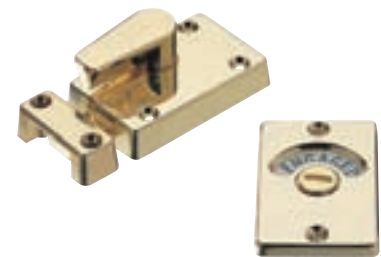
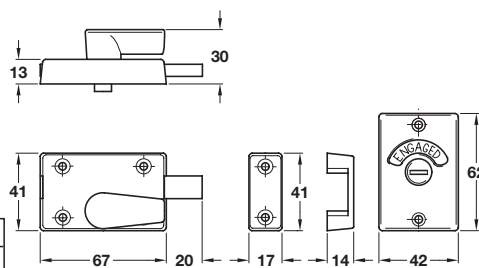

Satin stainless steel finish

D Indicator bolt

- Surface mounted
- To suit doors **28-48 mm** thick
- Emergency release to outside
- Throw over turn knob to inside
- Stainless steel

| Finish | Cat. No. |
|--------------------------|------------|
| Satin stainless steel | 911.62.267 |
| Polished stainless steel | 911.62.268 |

Order qty: 1 pc

